

EXISTING DOOR TO PERMANENTLY LOCKED.
 INTERIOR OPENING TO BE COVERED.
 FRAMING AND FINISH TO MATCH ADJACENT
 ROOMS. INTERIOR FINISH OF EXISTING
 DOOR AND FRAME.

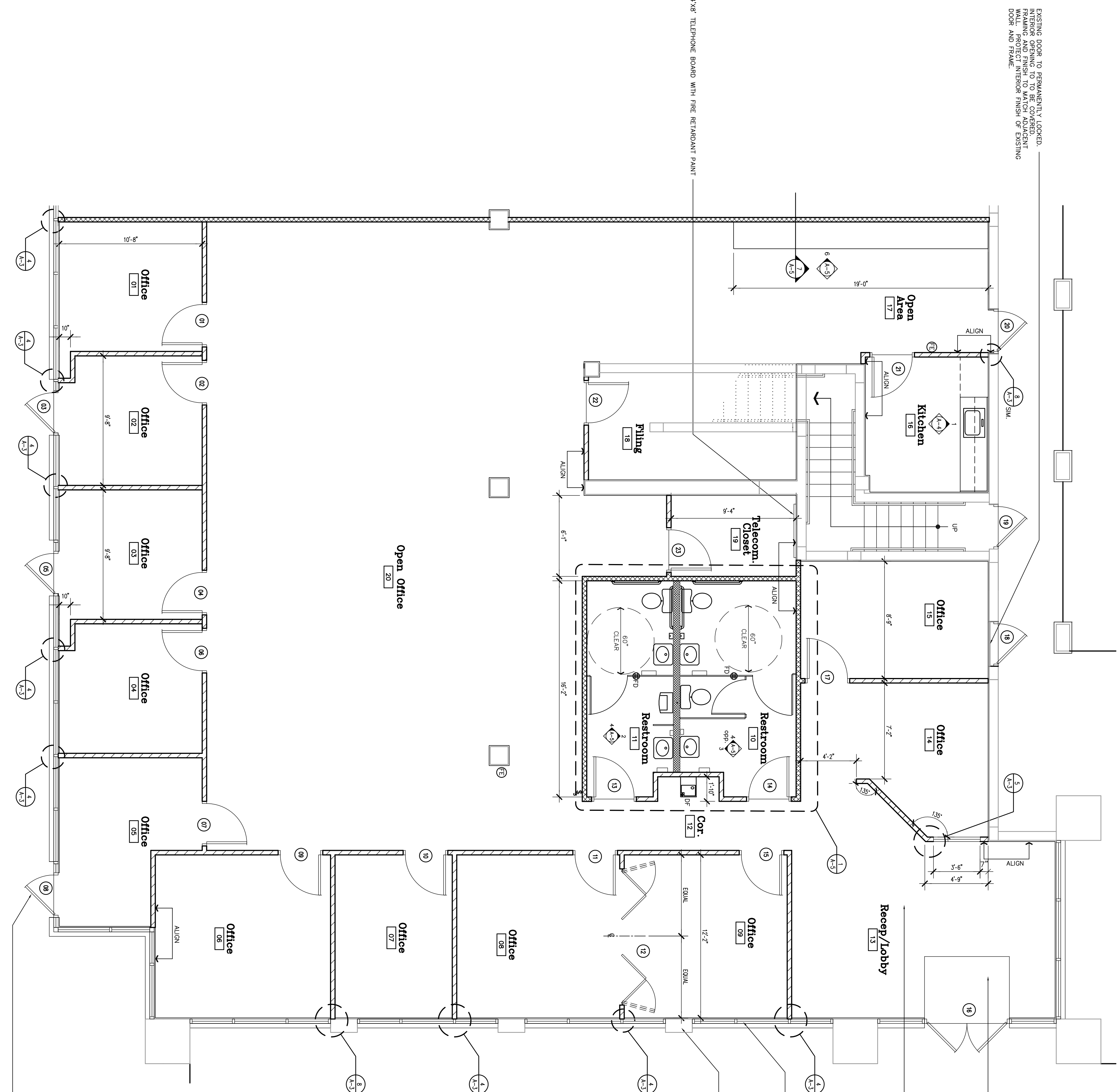

Legend

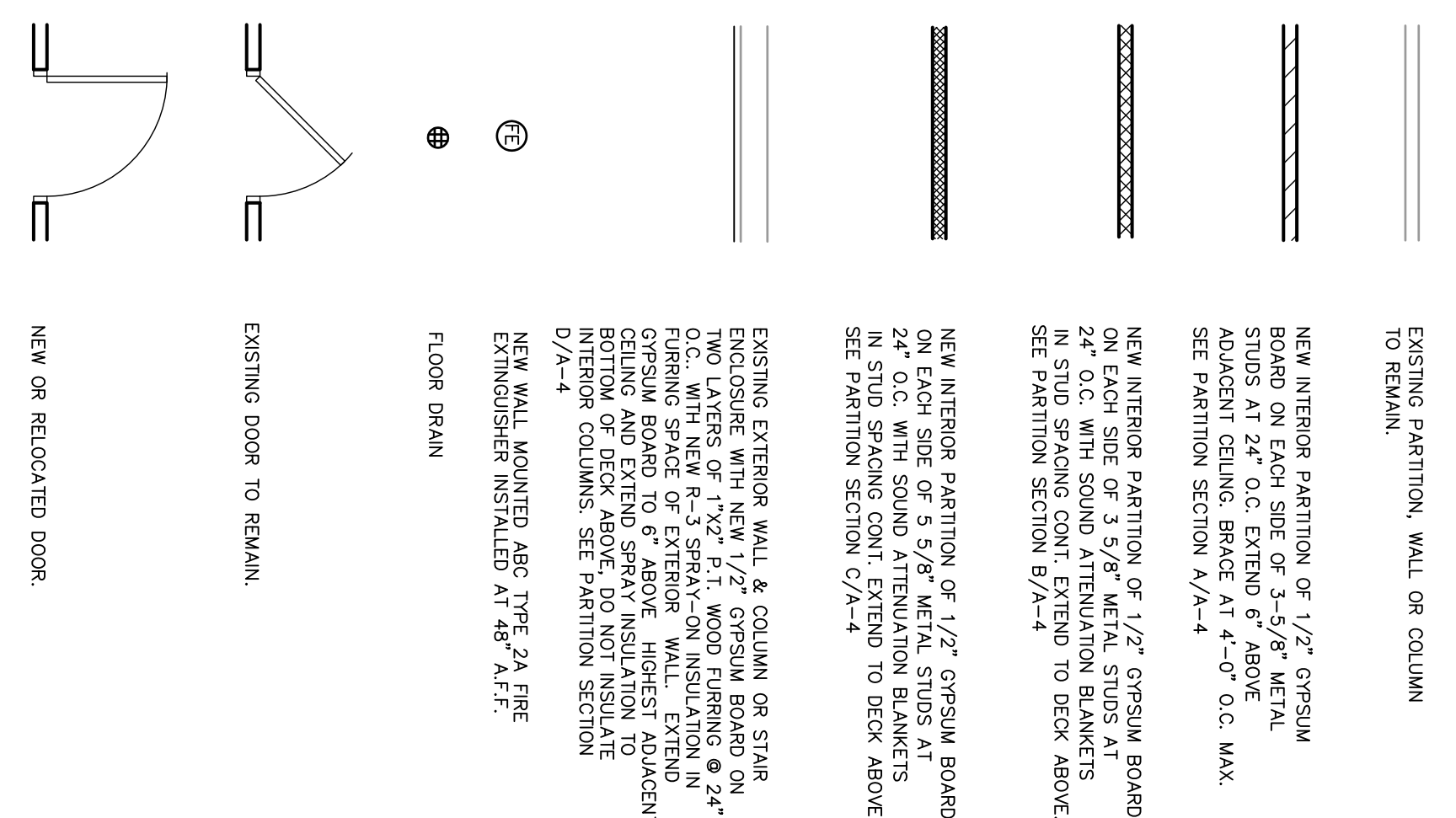

NOTES:

- THIS DESIGN COMPLIES WITH SECTION 4.1.6, 4.1.8 OF THE FLORIDA ACCESS CODE OF BUILDING CONSTRUCTION, OCTOBER 1997 EDITION, AND THE AMERICANS WITH DISABILITIES ACT.
- TENANT'S EQUIPMENT AND CASEWORK LAYOUT SHALL COMPLY WITH SECTIONS 6 AND 10 OF THE 2000 INTERNATIONAL BUILDING CODE. CONSTRUCTION MUST BE RECENT EDITION.
- PROVIDE DETAILED SHOP DRAWINGS FOR ALL CASEWORK PRIOR TO FABRICATION.
- VERIFY DIMENSIONS IN FIELD.
- PROVIDE HORIZONTAL BRACKING IN WALLS FOR ALL CASEWORK AND RESTROOM ACCESSORIES.
- 2"x4" WOOD BRACKING WHERE STUDS ARE AT 24" O.C.
- 2" X8" WOOD BRACKING WHERE STUDS ARE AT 48" O.C.
- ALL FLOOR SURFACES SHALL BE LEVELLED. ANY NECESSARY CHANGE IN LEVEL SHALL NOT EXCEED 1/2".
- BUILDING SHELL, EXTERIOR WALLS, EXTERIOR GLAZING, EXTERIOR DOORS, EXTERIOR FINISHES, EXTERIOR ROOFING SHALL BE COMPLETE AND EXISTING FOR THE PURPOSES OF THIS PERMIT.
- PROVIDE ONE - ABC TYPE, "2-A" RATED FIRE EXTINGUISHER FOR EACH 3,000 SQ. FT. OF FLOOR AREA. EXTINGUISHER SHALL BE INSTALLED NOT TO EXCEED 5 FT. ABOVE FINISH FLOOR.
- THIS BUILDING HAS A COMPLETE AND OPERATIONAL FIRE SMOKE ALARM SYSTEM.

Partial Floor Plan 1/4"

DOOR TO BE PERMANENTLY LOCKED.
 (TYPICAL OF DOORS 03, 05, 08 & 19)

Date	
Commission	
Revisions	<ul style="list-style-type: none"> 11-02-01 GEN. REV. 11-26-01 GEN. REV.
Sheet	A-1
1 of 5	

Project: _____
 Owner: _____