

Project: Miami Lakes Temporary Town Hall

Interior Improvements
15150 NW 79th Court
Miami Lakes, FL

The Graham Companies
6843 Main Street
Miami Lakes, FL 33014

Date	01-17-11
Commission	10117
Revisions	01-19-11 FIRE DEPT. 01-21-11 FIRE DEPT.

Sheet	A-1
1 of 3	

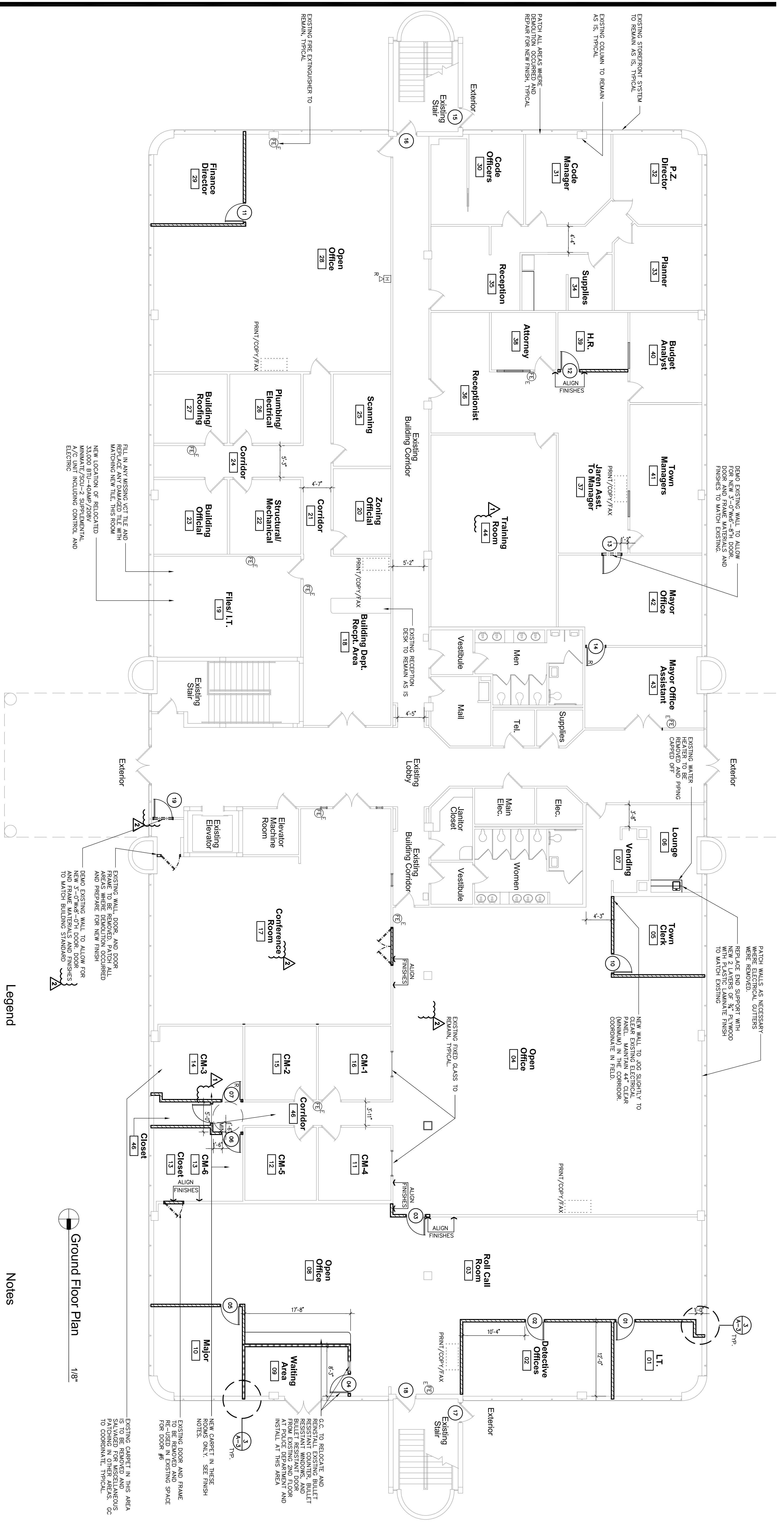

Interior Finish Material Classification

2007 NFPA 101 214, 102 and SPECIFIC OCCUPANCIES	EXITS	EXIT ACCESS CORRIDORS (CORRIDOR)	OTHER SPACES (LOBBY)
OCCUPANCY ASSEMBLY - NEW (NFPA 101 12.3.3)	WALL/CEILING - A (ENCLOSED STAIRWAYS)	WALL/CEILING - A or B	WALL/CEILING - A or B (300 OCCUPANTS) WALL/CEILING - A, B or C (300 OCCUPANTS)
BUSINESS - EXISTING (NFPA 101 39.3.3)	FLOOR - CLASS II FLOOR - NONE REQ.	FLOOR - CLASS II FLOOR - NONE REQ.	FLOOR - CLASS II FLOOR - NONE REQ.

- Legend**
- NEW INTERIOR PARTITION OF 1/2" Gypsum Board on each side of 3-5/8" metal studs at 24" o.c. extend to overhead of ceiling. See partition section A/A-3.
 - NEW INTERIOR PARTITION OF 5/8" Gypsum Board on each side of 3 5/8" metal studs at 24" o.c. extend to underside of ceiling. Provide fiberglass panel rated and underwriters laboratory (UL) standard 752 level III mounted on 3 5/8" studs between a layer and interior is not to exceed 1/2" suite. See partition section B/B-3.
 - EXISTING PARTITION, WALL OR COLUMN TO REMAIN
 - EXISTING TO BE REMOVED
 - INDICATES ELEMENT ABOVE
 - INDICATES EQUIPMENT N.L.C.
 - NEW WALL MOUNTED ABC TYPE 2A FIRE EXTINGUISHER INSTALLED AT 48" A.F.F. PROVIDES EQUIPMENT AND FURNITURE MOUNTED AND INSTALLED BY OWNER
 - EXISTING 3"-0" WIRE DOORS TO REMAIN WITH EXISTING HARDWARE
 - EXISTING DOOR TO BE REMOVED
 - NEW OR RELOCATED DOOR
- Notes**
- THIS DESIGN COMPLETES WITH SECTION 11, FLOORING SCHEDULE CODE.
 - REMOVE SCHEDULE CODE WITH SECTIONS 11-42 OF THE FLORIDA BUILDING CODE
 - ALL FLOOR SURFACES SHALL BE LEVELLED AND FLOORING MATERIALS SHALL BE REPLACED IN ORDER TO ALLOW GREATER RESISTANT COUNTER BULLET RESISTANT DOOR FROM EXISTING 2ND FLOOR POLICE DEPARTMENT AND AS FALL AT THIS AREA.
 - REMOVE ONE (1) ABC TYPE "2-A" RATED MAX. 75 FT. OF TRAVEL TOP OF FINISH FLOOR
 - FLOOR SURFACES SHALL COMPLY WITH SECTION 11-45 OF THE FLORIDA BUILDING CODE
 - PROVIDE SUPPORTS AND BACKING AS PER MOUNTED FIXTURES AND ACCESSORIES.
- Finish Notes**
- AREA OF WORK TO RECEIVE:
- PAINT WITH ONE COAT OF INTERIOR LATEX PAINT BY "DITTSER" BRANDS' FLAT FINISH THROUGHOUT. COLOR SELECTION BY LANDLORD
 - CARPETS 13 AND 14 AND CORRIDOR 46 ARE TO RECEIVE NEW CARPET AS SELECTED BY OWNER. ALL OTHER EXISTING CARPET IS EXISTING TO REMAIN, TYPICAL.
- Ground Floor Plan 1/8"**